



# LXLN-(50-300)

## Agriculture Irrigation Water Meter

# LXLN-(50-300)

Agriculture Irrigation Water Meter ▼

## Type

Dry dial ,Detachable ,Horizontal

## Function

Measuring the volume of cold or hot water passing through the pipeline

## Feature

Large flow capacity and small pressure lose.

This type water meter is very fit for agriculture irrigation and bad water quality.

- High quality material applied to guarantee its function efficient and reliable.
- Magnet-drive, dry dial,protected by the steel cover,register sealed in vacuum, resistance to magnet and fog-proof, forever clean and legible dial for reading.
- Register may be rotated through 360°
- Removable mechanism is easy to replace or fix and not required detaching the body from the pipeline.

Pulse emitter can be installed to this type for remote reading(option)

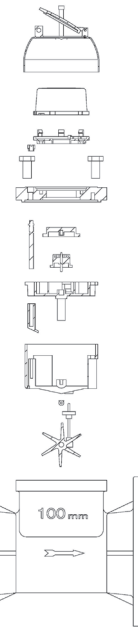

Head Loss Curve

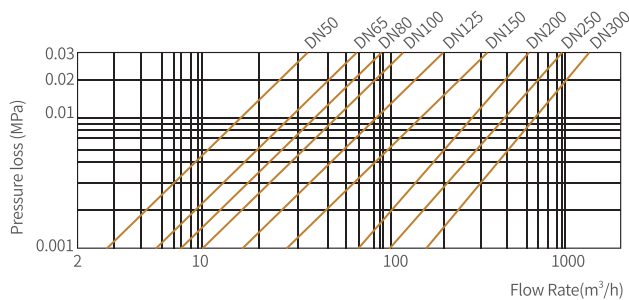

Error Curve

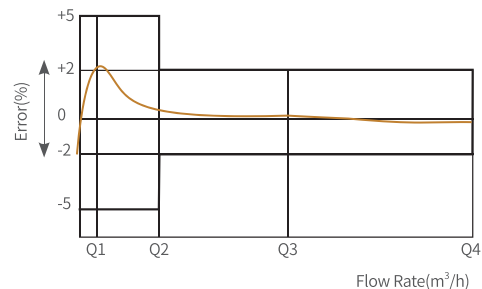

### HYDRAULIC PERFORMANCE

Size	mm	50	65	80	100	125	150	200	250	300
	inches	2"	2½"	3"	4"	5"	6"	8"	10"	12"
Metrological class		R20/R25/R40								
		Q2/Q1 ≤ (1.6、4、6.3)								
Q3	m³/h	25/40	40	63	100	160	250	400	630	1000

### TECHNICAL SPECIFICATIONS

Maximum permissible error Between Q1and Q2(excluded)		±5%								
Maximum permissible error Between Q2(included)and Q4		±2% with water temperature ≤ 30°C ±3% with water temperature >30°C								
Temperature class		Cold water:0°C ~45°C Hot water:45°C ~90°C								
Nominal pressure	bar	10/16	10/16	10/16	10/16	10/16	10/16	10/16	10/16	10/16
Min reading	m³	0.001	0.001	0.001/0.01	0.001/0.01	0.01	0.01	0.01	0.01	0.01
Max reading	m³	9,999,999	9,999,999	99,999,999	99,999,999	99,999,999	99,999,999	99,999,999	99,999,999	99,999,999
Weight	kg	10.5	12	15.5	17.5	19	30.5	44	70	85
Pulse options	l/imp.	10-1000	10-1000	100-10000	100-10000	100-10000	100-10000	100-10000	100-10000	100-10000
				10-1000	10-1000					

### DIMENSIONS

L	mm	200	200	225	250	250	300	350	450	500
W	mm	185	185	200	215	250	285	340	405	460
H	mm	253	268	284	295	310	339	382	450	480

### CONNECTING BOLTS

Outside diameter	mm	165	185	200	220	250	285	340	460	460
Bolt circle diameter	mm	125	145	160	180	210	240	295	355	410
Connecting bolts		4-M16	4-M16	8-M16	8-M16	8-M16	8-M20	8/12-M20	12-M20	12-M20